

# Moulding Technology Training

Understanding  
Processing  
Technology  
2 day course

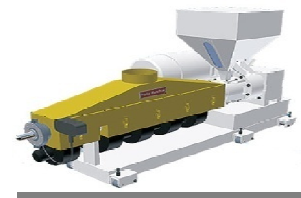
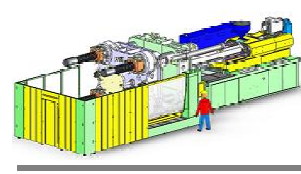

**POLYBRIDGE Training Ltd**

*"A short course that explains the major moulding forming & assembly methods".*

*"It won't make you an expert but it helps you understand the technicalities: without blinding you with science!"*

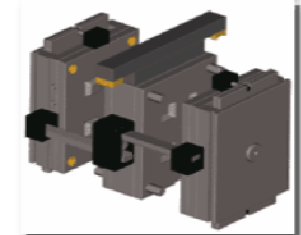

info@polybridgetraining.co.uk

www.polybridgetraining.co.uk

T. +44 (0) 17 46 761 875

F. +44 (0) 17 46 761 875

M. +44 (0) 77 74 732 129

Voip. Skype Polybridge1

2010

January 19<sup>th</sup> & 20<sup>th</sup>

May 26<sup>th</sup> & 27<sup>th</sup>

August 24<sup>th</sup> & 25<sup>th</sup>

Nov 9<sup>th</sup> & 10<sup>th</sup>

# Understanding Processing Technology

*"A short course that explains the basics. It won't make you an expert, but it will help you to understand the technicalities, without blinding you with science!"*

## Who is for?

This 2-day course is intended to for anyone new to plastics or with very little or no knowledge of its processing technologies, & has been designed to assist:

- **Purchasing & procurement** staff.
- **Product Designers; Polymer suppliers.**
- **Packaging technologists**
- **QA Engineers. Liaison Engineers**
- **Management Sales & Marketing** staff,

The course will also benefit anyone changing roles, which now involve plastic processes or products, as well as improving their communication skills when dealing with customers, suppliers and colleagues.

## Course Objectives

- To provide a basic understanding of plastics processes & materials
- Allow you to evaluate technical issues & contribute in the decision making process confidently
- Improve communication with customers & suppliers
- Assess the value of the solutions being offered

*Note: This course will also provide a basis for further training in more detailed aspects of plastics technology.*

## Content

### Introduction

- Everyday terms used in Plastics processing
- What's possible with plastic
- Identifying manufacturing methods
- Identifying end use limitations
- Assessing designs for manufacture
- Comparative manufacturing costs

### Basic polymer Technology

- Thermoplastics and thermosetting plastics
- Strengths & Weaknesses
- Material selection

### Plastics materials: Basic properties

- The physical and chemical properties of plastics
- Comparison with other materials
- Commodity Thermoplastics
- Engineering thermoplastics
- Thermosetting plastics
- Fillers & additives
- Cost factors

### Processing technologies: comparison application & use

- Injection moulding
- Extrusion (pipe, film sheet etc)
- Blow moulding
- Vacuum forming
- Rotational moulding
- Machining
- Cost comparison
- Choosing between processes; basic criteria

### Moulds & tooling

- Tooling: cost comparison
- Quantity requirements
- What can & can't be done

### Assembly Methods;

- Automation possibilities
- Welding (Ultrasonic, vibration etc)
- Assembly (snap fits, screws etc)
- Costs in assembly

### Product Aesthetics Finishing & decoration

- Decoration methods
- In Mould techniques
- Plating
- Labels
- Mould surface texture
- Prototype moulds

### Cost reduction Methods

- Identifying cost reduction areas
- Assessing cost reduction implications
- Assessing designs for economic production

### Plastics and the environment:

- Recycling-legislation

### Future developments:

- Brief introduction to new materials and processes
- Rapid manufacturing & prototyping

---

**Locations** Stafford & Telford

**Course Fee:** £525.00 + VAT per person and includes course materials, lunch and refreshments.

### Tailor Made "In-House" Courses

This has for many years been our core business, providing cost effective training that meets the company's individual needs, and delivered to suit their schedules, whether on or off-site. Please contact us if this is right for you.

# Registration Form

Understanding Processing Technology

Fax to +44 (0) 1746 761 875

Email to [info@polybridgetraining.co.uk](mailto:info@polybridgetraining.co.uk)

## Select Desired Course Date: 2010

Please use a separate form for each delegate, photocopies are acceptable

Jan 19<sup>th</sup> & 20<sup>th</sup>     May 26<sup>th</sup> & 27<sup>th</sup>     August 24<sup>th</sup> & 25<sup>th</sup>     Nov 16<sup>th</sup> & 17<sup>th</sup>

Surname: \_\_\_\_\_ Title \_\_\_\_\_

Forename: \_\_\_\_\_

Position/ Job Title \_\_\_\_\_

Company: \_\_\_\_\_

### Contact Details;

Company \_\_\_\_\_

Contact name \_\_\_\_\_

(If different from above)

Address: \_\_\_\_\_

\_\_\_\_\_

\_\_\_\_\_

\_\_\_\_\_

Postcode: \_ \_ \_ \_ \_

Tel: \_\_\_\_\_

Fax \_\_\_\_\_

Email \_\_\_\_\_

### Invoice Address (if different from Contact Details opposite)

Company \_\_\_\_\_

Contact \_\_\_\_\_

Address \_\_\_\_\_

\_\_\_\_\_

\_\_\_\_\_

\_\_\_\_\_

Postcode \_\_\_\_\_

Tel \_\_\_\_\_

Fax \_\_\_\_\_

Email \_\_\_\_\_

### Payment Information

#### NOTE:

Payment must be received prior to attending the course

Cheque payable to "Polybridge Training Ltd"

Payment enclosed

Please Invoice my company:

Purchase Order No: \_\_\_\_\_

NOTE: Please read this carefully

Cancellation Terms,

By completing & returning this registration form, delegates are agreeing to be bound by the Conditions of Registration which can be found on the following page.

Full terms & conditions can be found on our website:

[www.polybridgetraining.co.uk/downloads/calculator/terms](http://www.polybridgetraining.co.uk/downloads/calculator/terms)

Please return to:

Training /Seminars,  
Polybridge Training Limited  
42 Linley View Drive,  
Bridgnorth,  
Shropshire.  
WV16 4RT  
United Kingdom.

Fax +44 (0) 1746 761 875

[Info@polybridgetraining.co.uk](mailto:Info@polybridgetraining.co.uk)

## **BOOKING TERMS & CONDITIONS**

### **Payment is accepted in £GB**

Discounts given for multiple registrations: 10% discount for 2 or more delegates from the same company registering at the same time for the same dates

### **Conditions of Registration**

Written confirmation is required: letter, fax, email.

**Payment must be received prior to attending the course.**

**Accommodation** is NOT included in the fee.

**Cancellation** up to 14 days prior to the course start date will be refunded minus a 20% administration charge. Cancellation after this date will be subject to the FULL fee with NO REFUND.

**Transfer** to a later course, prior to the course start date can be accommodated without charge.

Transfer within the 14-day period prior to course start date will incur a 20% administration charge.

All transfer requests must be confirmed in writing by the delegate requesting transfer or their representative. The option to transfer can only be used once after which non-attendance will be treated as a cancellation subject to the terms above

**Delegate substitutions** can be made without incurring penalty

### **Locations**

The final course delivery location will be advised at the time of booking. Location choice is dependent on majority course candidates moulding discipline and travel logistics.

### **Tailor Made "In-House" Courses**

This has for many years been our core business, providing companies with cost effective solutions to meet their own specific needs.

Please contact us if this route will be more effectively meet your company's individual needs.



# **POLYBRIDGE Training Ltd**

Registered Business Address Co Reg 4683206 VAT No:559 444 115

Director; D.J. Jeavons. Company Secretary S.Jeavons

42 Linley View Drive, Bridgnorth, Shropshire, WV16 4RT, ENGLAND. UK.

Tel: +44 (0) 1746 761 875

Mob: +44 (0) 7774 732 129

[info@polybridgetraining.co.uk](mailto:info@polybridgetraining.co.uk) [www.polybridgetraining.co.uk](http://www.polybridgetraining.co.uk)